

The Clipper Prelude 526

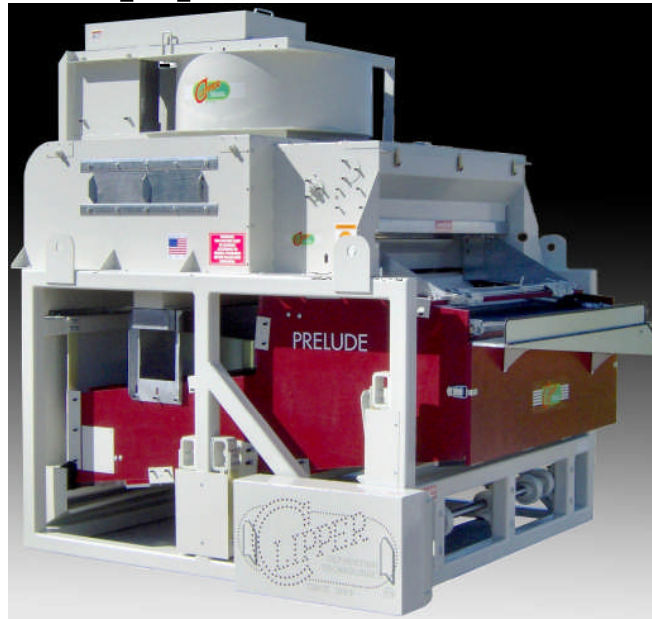

Technical Specifications

● Extreme Height	91" /232 cm
● Extreme Width	78.5"/200 cm
● Extreme Length	91.5"/233 cm
● Width on Floor	69.5"/177 cm
● Length on Floor	73.5"/187 cm

Capacities*

● Small Seed	100 Bu./Hr. (1.3 MT/Hr.)
● Medium Seed	175 Bu./Hr. (3.1MT/Hr.)
● Large Seed & Wheat	200 Bu./Hr. (5.4 MT/Hr.)
● Market Cleaning	600 Bu./Hr. (16.3 MT/Hr.)

Electrical Requirements

● Main Fan Motor	10 H.P./7.5 Kw
● Eccentric Motor	2 H.P./1.5 Kw
● Vibratory Feeder Motor	Optional

Options

- Electronic Variable Speed hopper
- Electronic Variable Speed Shoe Shake
- Grease Line Package

Air Output

6,000 CFM

Features

- Heavy duty construction – Easily Portable

*Note: Capacities may vary depending on seed condition, moisture content, seed varieties, types and volumes of contaminants to be separated and the percentage of foreign material acceptable in the final product.



1440 SOUTH ADAMS STREET, BLUFFTON IN 46714 (260) 824-3400, (800) 248-8318, FAX (260)-824-5463

info@atferrell.com

www.clipperseparation.com

RIGHT HAND SIDE VIEW
PRE-SCALP, SPLIT SIFT

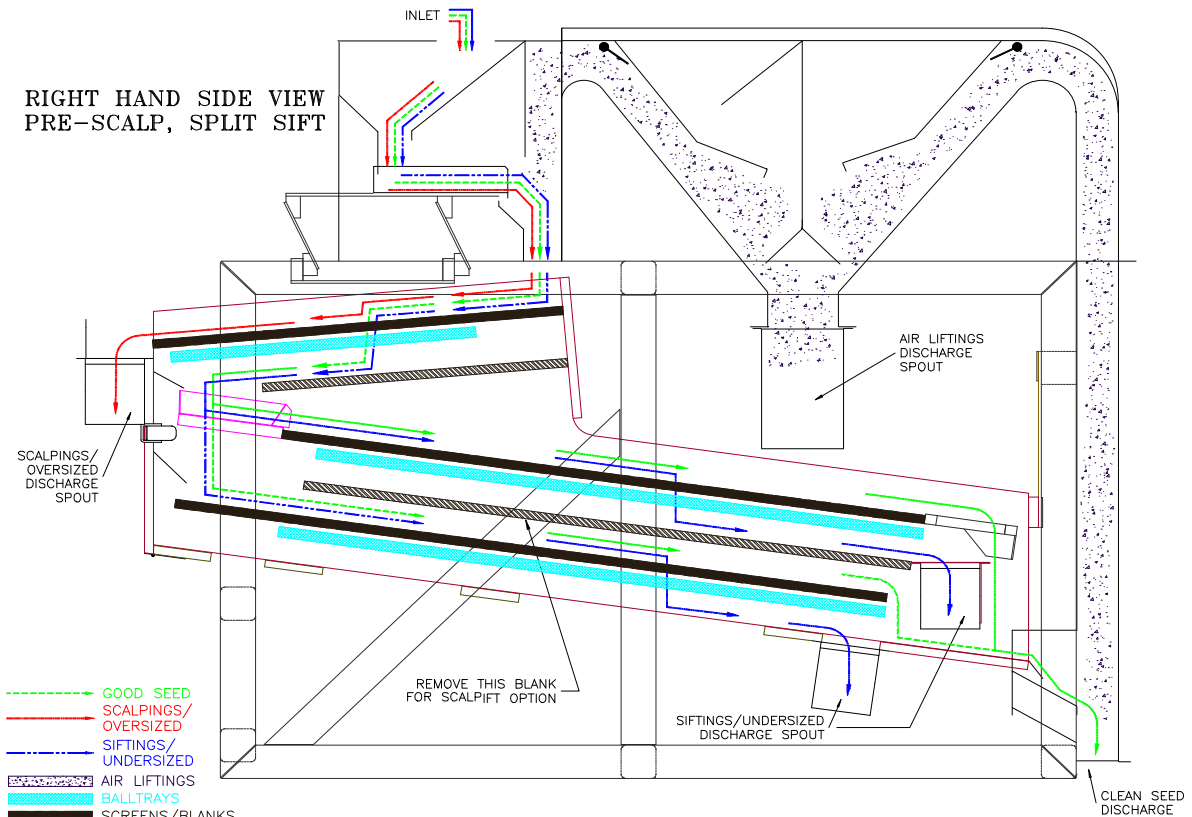

RIGHT HAND SIDE VIEW
PRE-SCALP, SCALP/SIFT

